



The product is installed in these energy transmission lines:

TR60	continuous
TR60	pre-mounted
TR85H5P	continuous
TR85H5P	pre-mounted
TR85H7P	continuous
TR85H7P	pre-mounted

INSTRUCTION
MANUALS



Please find the relevant reference guides on our instruction manuals page:
<https://www.giovenzana.com/leaflets/>

TR8557

TOWING ARM WITH CHAIN

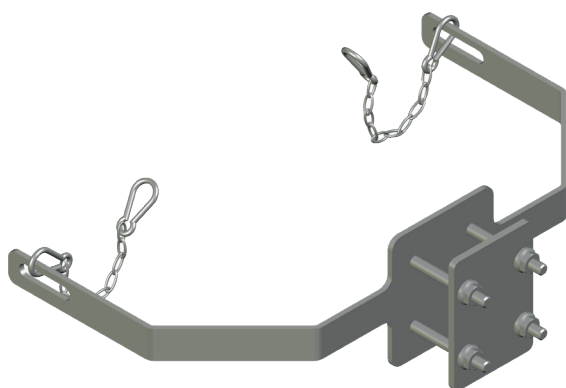

Material	body	galvanized steel
	hardware	galvanized steel
Weight		~1.4 kg

