



SQN125... / SQN160... additional poles

ADDITIONAL POLES FOR REGOLUS SWITCH DISCONNECTORS (125 A / 160 A)

		Panel mounting	Base mounting
Additional pole NO		 SQN125AFPR SQN160AFPR	 SQN125AFPB SQN160AFPB
Fourth pole, early make contact (NO)		 SQN125ANIR SQN160ANIR	 SQN125ANIB SQN160ANIB
Neutral terminal		 SQN125ANPR SQN160ANPR	 SQN125ANPB SQN160ANPB
Ground terminal		 SQN125APER SQN160APER	 SQN125APEB SQN160APEB

SPECIFICATIONS

General characteristics

Connections	terminal block caliber	EN60947-1	A11	
	terminal screw		M8	
	tightening torque	EN60947-1 UL508	6 N·m 53 lb·in (6 N·m)	
Connectable section	flexible conductors		SQN125 SQN160	50 mm ² / AWG 0 70 mm ² / AWG 00
Contacts			slow action, double breaking	

EN 60947-3 characteristics

			SQN125...	SQN160...
Rated operating voltage	U _e		690 V	690 V
Rated insulation voltage	U _i		800 V	800 V
Rated impulse withstand voltage (sectionable)	U _{imp}		8 kV	8 kV
Rated thermal current	I _{th}		125 A	160 A
Rated enclosed thermal current	I _{the}		125 A	160 A
Frequency			50/60 Hz	50/60 Hz

Rated operating current (I_e)

			SQN125...	SQN160...
AC-21A		690 V	125 A	160 A
AC-22A		690 V	125 A	160 A
AC-23A	3 phases - 3 poles	400 V	125 A	160 A

Short circuit characteristics

			SQN125...	SQN160...
Rated short-time short circuit withstand current (1 s)	I _{cw}		3000 A	3000 A
Rated short circuit making capacity	I _{cm}		4500 A	4500 A
Conditional rated short circuit withstand current			10 kA	10 kA
Fuse rating (type gG)		690 V	125 A	125 A

UL508 characteristics

			SQN125...	SQN160...
General use		600 V AC	125 A	150 A
Standard motor load	3 phases - 3 poles	240 V AC	25 HP	25 HP

Marking - Compliance by passed test: CE / Approved: UL (SQN160 models are are not UL approved)

OVERALL DIMENSIONS

Panel mounting

Base mounting

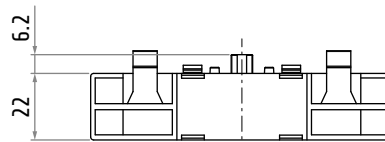
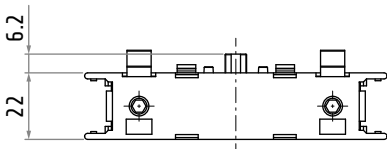
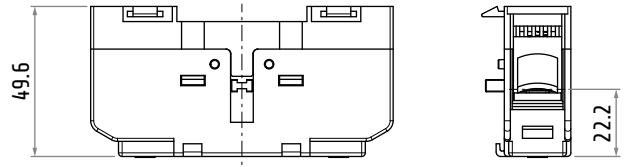
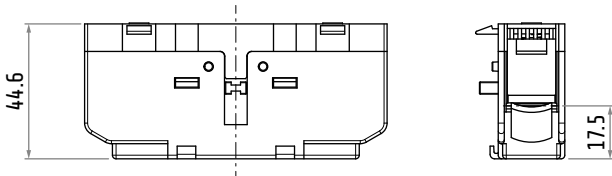
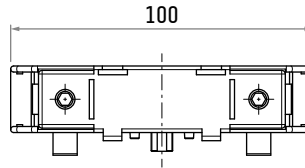
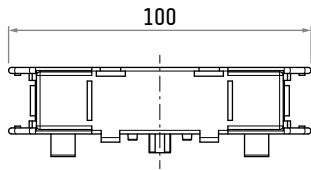

Additional pole (NO)

Fourth pole, early make

Additional pole (NO)

Fourth pole, early make

SQN125AFPR
SQN160AFPR

contact (NO)
SQN125ANIR
SQN160ANIR

SQN125AFPB
SQN160AFPB

contact (NO)
SQN125ANIB
SQN160ANIB

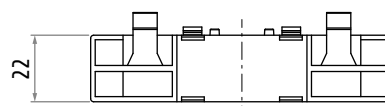
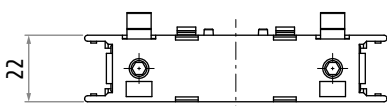
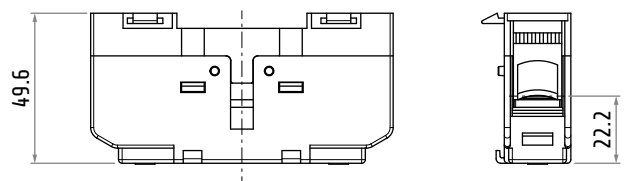
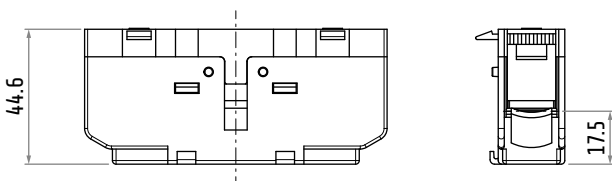
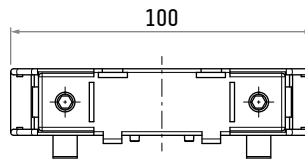
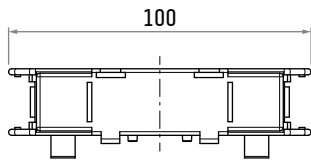

Neutral terminal

Ground terminal

Neutral terminal

Ground terminal

SQN125ANPR
SQN160ANPR

SQN125APER
SQN160APER

SQN125ANPB
SQN160ANPB

SQN125APEB
SQN160APEB

Dimensions in mm / illustrations NOT in scale