



SQ025... / SQ032... additional poles

ADDITIONAL POLES FOR REGOLUS SWITCH DISCONNECTORS (32 A / 40 A)

		Panel mounting		Base mounting	
Additional pole NO			SQ025AFPR SQ032AFPR		SQ025AFPB SQ032AFPB
Fourth pole, early make contact (NO)			SQ025ANIR SQ032ANIR		SQ025ANIB SQ032ANIB
Neutral terminal			SQ025ANPR SQ032ANPR		SQ025ANPB SQ032ANPB
Ground terminal			SQ025APER SQ032APER		SQ025APEB SQ032APEB

SWITCH DISCONNECTORS SPECIFICATIONS

General characteristics

Connections	terminal block caliber	EN60947-1	A6
	terminal screw		M4
	tightening torque	EN60947-1 UL508	1.2 N·m 7 lb·in (0.8 N·m)
Connectable section	flexible conductors		1.5 ... 10 mm ² / AWG 12 ... 8
	solid conductors		1.5 ... 10 mm ² / AWG 12 ... 8
Contacts			slow action, double breaking

EN 60947-3 characteristics

			SQ025...	SQ032...
Rated operating voltage	U _e		690 V	690 V
Rated insulation voltage	U _i		690 V	690 V
Rated impulse withstand voltage (sectionable)	U _{imp}		8 kV	8 kV
Rated thermal current	I _{th}		32 A	40 A
Rated enclosed thermal current	I _{the}		32 A	40 A
Frequency			50/60 Hz	50/60 Hz

Rated operating current (I_e)

			SQ025...	SQ032...
AC-21A		690 V	32 A	40 A
AC-22A		690 V	25 A	32 A
AC-23A	3 phases - 3 poles	400 V	25 A	32 A
AC-3	3 phases - 3 poles	400 V	22 A	27 A

Short circuit characteristics

			SQ025...	SQ032...
Rated short-time short circuit withstand current (1 s)	I _{cw}		800 A	800 A
Rated short circuit making capacity	I _{cm}		1500 A	1500 A
Conditional rated short circuit withstand current			10 kA	10 kA
Fuse rating (type gG)		690 V	40 A	40 A

UL508 characteristics

			SQ025...	SQ032...
General use		600 V AC	32 A	40 A
Standard motor load	1 phase - 2 poles	200 - 208 V AC	2 HP	3 HP
	3 phases - 3 poles	200 - 208 V AC	7.5 HP	10 HP

Marking - Compliance by passed test: CE / Approved: UL

OVERALL DIMENSIONS

Panel mounting

Base mounting

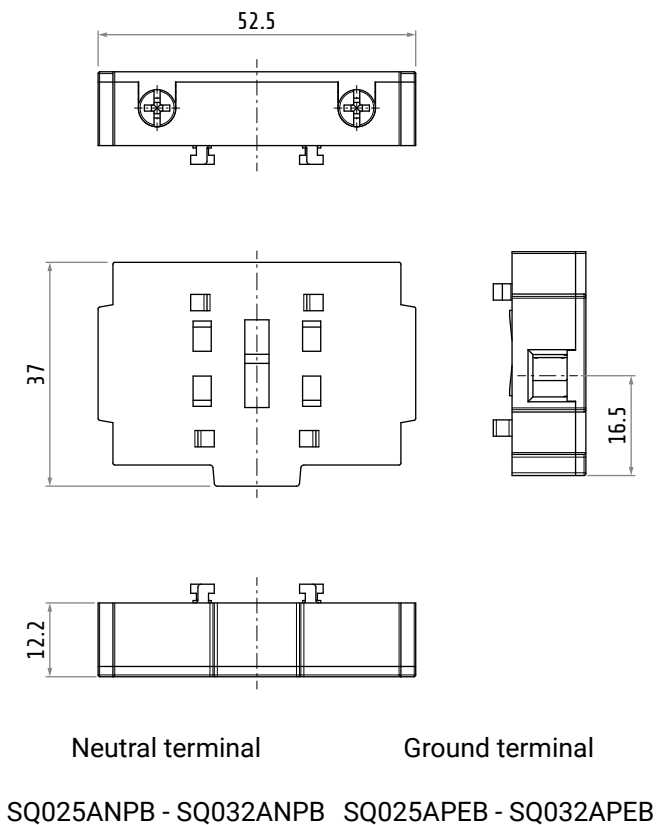
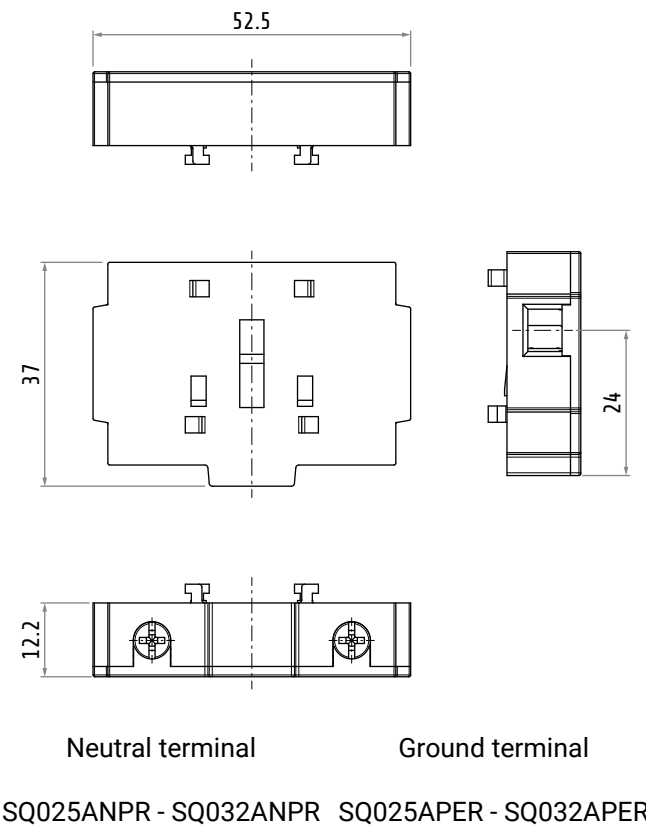
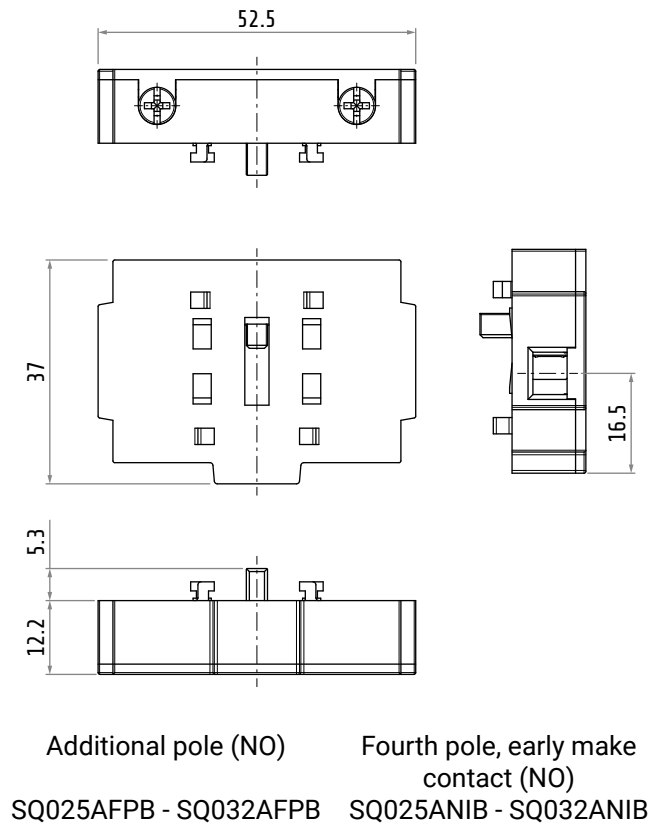
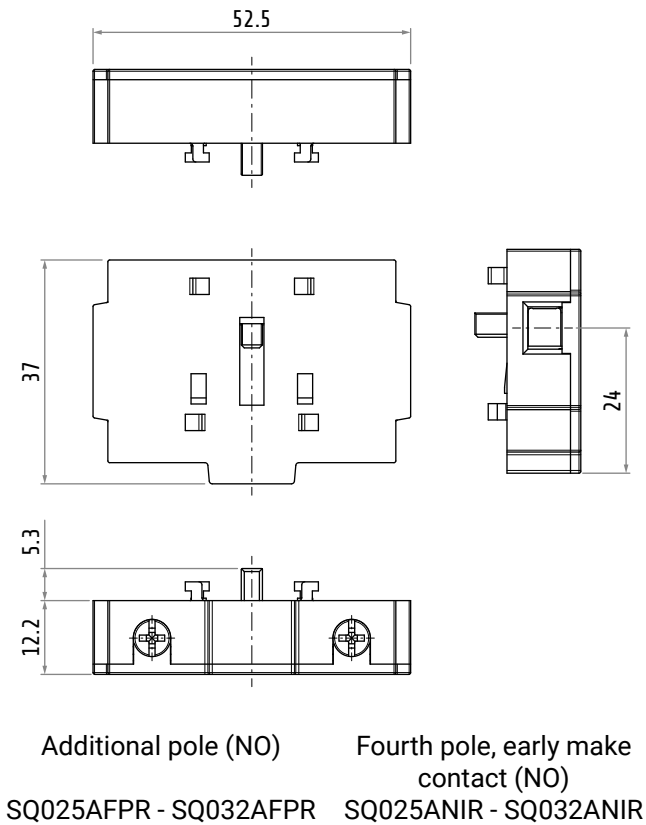

Dimensions in mm / illustrations NOT in scale