

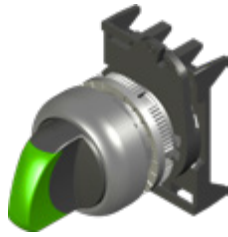

# PSML...GL



PSML1...GL



PSML2...GL



PSML3...GL



PSML4...GL



PSML5...GL

## ORION SERIES GREY LINE ROTARY SWITCH WITH LIGHT OPERATOR

Series	Orion
Line	Grey Line
Type	rotary switch
Operator	light
Fixing	Ø22
Panel thickness	1 ... 6 mm
Drilling template compliance	IEC/EN60947-5-1 CENELEC EN50007
Mechanical life	0.5×10 <sup>6</sup> operations
IP rating	IP65
Material	thermoplastic
Marking	CE, UKCA

Code	Colour
PSML1...GL	red
PSML2...GL	green
PSML3...GL	yellow
PSML4...GL	blue
PSML5...GL	white

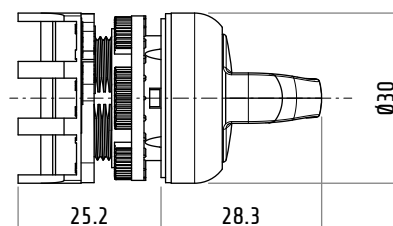
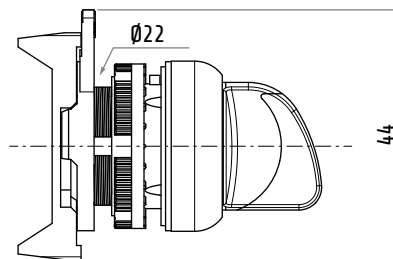
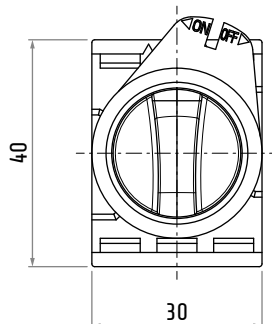

Dimensions in mm / Illustrations NOT in scale

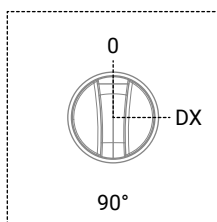

PSML1D0GL	red
PSML2D0GL	green
PSML3D0GL	yellow
PSML4D0GL	blue
PSML5D0GL	white
PSML8D0GL	black

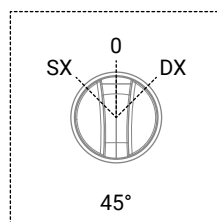

PSML1T0GL	red
PSML2T0GL	green
PSML3T0GL	yellow
PSML4T0GL	blue
PSML5T0GL	white
PSML8T0GL	black

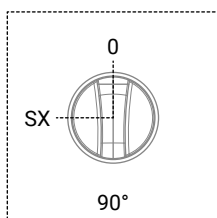

PSML1SDGL	red
PSML2SDGL	green
PSML3SDGL	yellow
PSML4SDGL	blue
PSML5SDGL	white
PSML8SDGL	black

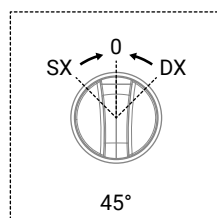

PSML1T3GL	red
PSML2T3GL	green
PSML3T3GL	yellow
PSML4T3GL	blue
PSML5T3GL	white
PSML8T3GL	black

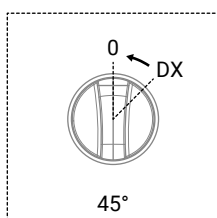

PSML1D2GL	red
PSML2D2GL	green
PSML3D2GL	yellow
PSML4D2GL	blue
PSML5D2GL	white
PSML8D2GL	black

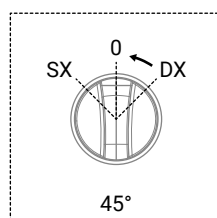

PSML1T2GL	red
PSML2T2GL	green
PSML3T2GL	yellow
PSML4T2GL	blue
PSML5T2GL	white
PSML8T2GL	black

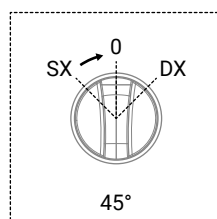

PSML1T1GL	red
PSML2T1GL	green
PSML3T1GL	yellow
PSML4T1GL	blue
PSML5T1GL	white
PSML8T1GL	black