



PCW010SS

PCW010SS

SELF-MONITORED CONTACT BLOCK WITH SPRING LOADED CONTACTS

Contact type	NO-NC-NO		self-monitored contact
Operating force			4 N
Connections	terminal type		spring
Connectable section	flexible conductors	1 or 2	1 ... 2.5 mm ²
	solid conductors	1 or 2	1 ... 2.5 mm ²
	wire peeling length		8 mm
Contacts			slow action, double breaking
Electrical lifetime	AC-15	1 A	1.5 million cycles
		2 A	0.5 million cycles
		3 A	0.25 million cycles
Marking			CE, IMQ, RINA, EAC, CCC, UL, UKCA

EN 60947-5-1 characteristics

Rated insulation voltage	Ui	690 V *
Rated impulse withstand voltage	Uimp	4 kV *
Rated thermal current	Ith	16 A *
Rated enclosed thermal current	Ithe	10 A
Frequency		50/60 Hz

Rated operating current (Ie)

AC-15	4.5 A	400 V	DC-13	0.25 A	220 V
-------	-------	-------	-------	--------	-------

Short circuit characteristics

Conditional rated short circuit withstand current	1000 A *	
Fuse rating (type gG)	500 V	10 A *
Contact insulation resistance	≤ 25 mΩ	

UL 508 characteristics

Rated insulation voltage	Ui	10 A	600 V AC
		2.5 A	125 V DC
Rated impulse withstand voltage	Uimp	A600	Q600

* IMQ approved values

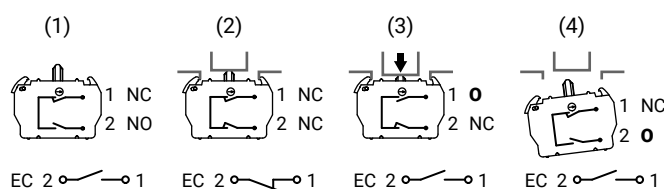

Diagrams

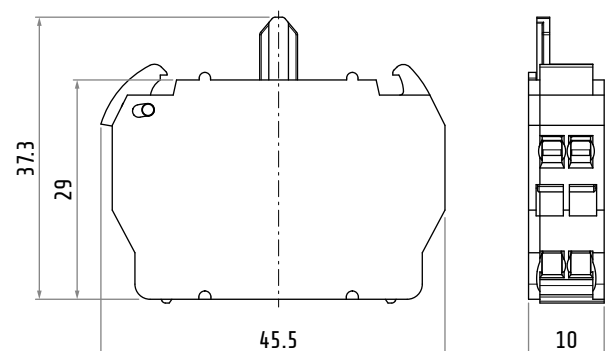
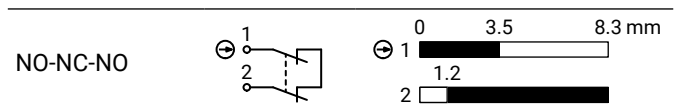

Dimensions in mm / illustrations NOT in scale

contact	status
(1) not installed	rest position, open
(2) installed	guard position, closed
(3) triggered	intervention position, open
(4) detached	malfunction, open
EC = equivalent circuit	