



The product is installed in these energy transmission lines:

Festoon System Line 41

Please find the relevant reference guides on our instruction manuals page:

<https://www.giovenzana.com/leaflets/>

INSTRUCTION  
MANUALS



# 30602091

## TOWING TROLLEY FOR FLAT CABLE

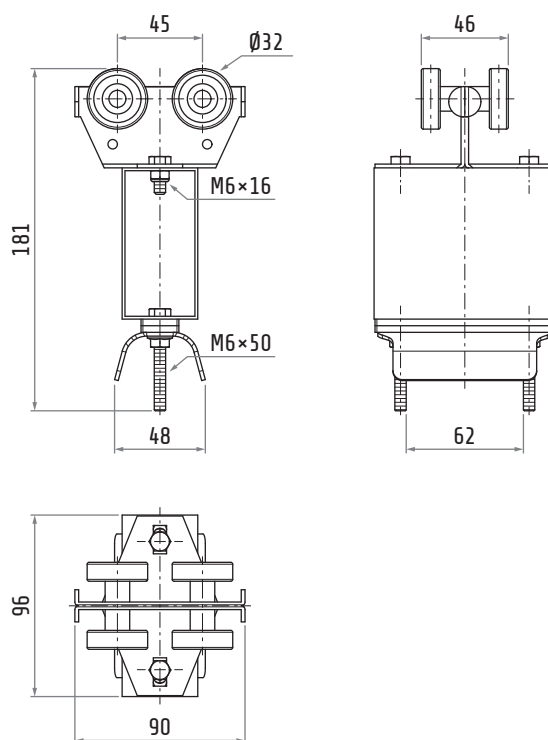
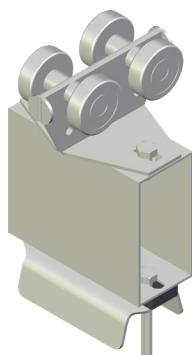

Material	body	galvanized steel
	hardware	galvanized steel
	rollers	covered ball bearings
	separator	thermoplastic
Weight		~870 g
Saddle		68 mm
Excursion		30 mm